



Village of Mount Prospect

Retail Shopping Center Listings

3. Randhurst Crossing

1 West Rand Road

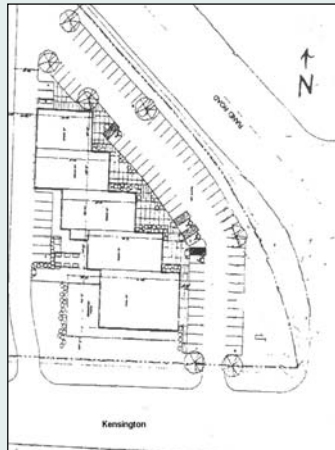
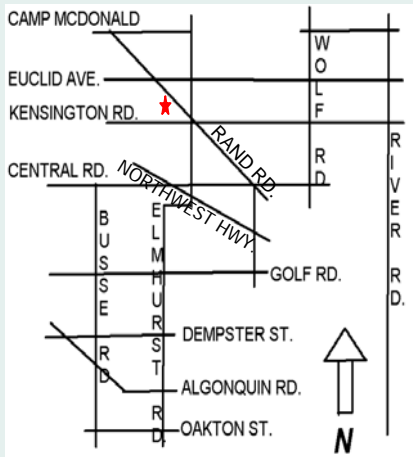

Location:

North West Corner of Rand Road/
Kensington/Route 83

Tenants:

Boston Market, Palm Beach Tan, Quizno's,
Verizon Wireless, and Starbuck's

Avail. Area: 1,600 – 3,200 sq. ft.

Total Area: 17,700 sq. ft.

Parking: 70 Spaces

Traffic: 25,700 vehicles/day on
Rand Road.

Zoning: B3 Community Shopping
District

Contact/Owner:

Eric Covelli and Ron Reese
Coldwell Banker Commercial
847-606-2221 (Eric) or
847-322-8716 (Ron)